



Club & Ball Washer, Inc.

# Universal Adjustable Post Mount

UNIVERSAL POST BRACKET



## Step: 1

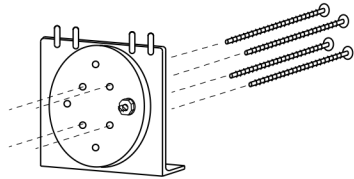

Locate a post or support bracket on the rear of your golf cart to mount your Golf Ball Washer. Use either the four inside holes on part A, or the outside holes on part A to insert bolts into.

Note: If using four outside holes, remove bolt holding parts A, B, and C together. This bolt will not be required if using the four outside holes.

## Step: 4

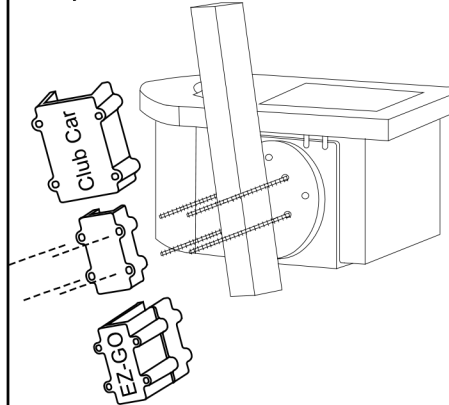

Choose one of the end caps provided to fit tightly around post, or support bracket.

Note: End Cap marked "Club Car", will only work if using the four outside holes on part A.

## Step: 2

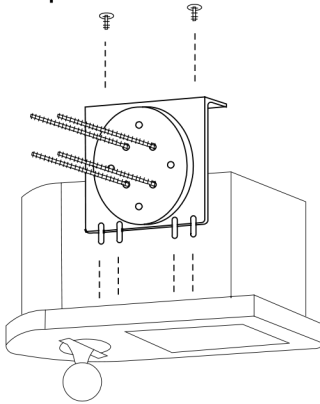

Turn your Club & Ball Washer unit upside down and locate four holes on the under side of the lid. Insert the four fingers on part B into these holes. Take two #10 3/4" black screws, and secure them into the screw bosses on the bottom of Club & Ball Washer Unit.

## Step: 5

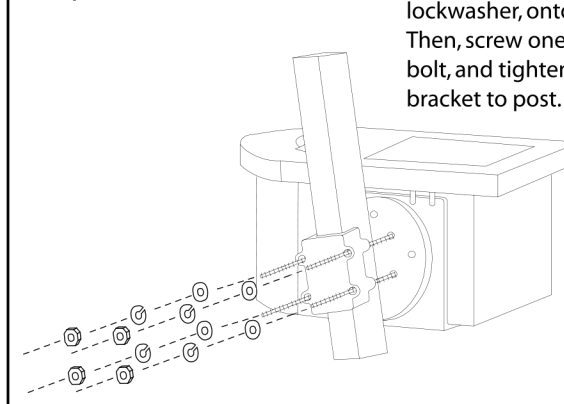

Slide one flat washer, then one lockwasher, onto each bolt. Then, screw one nut onto each bolt, and tighten to secure bracket to post.

## Step: 3

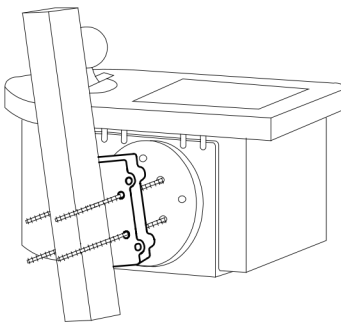

Slide the "optional" part D onto the four bolts using either the four inside holes, or the four outside holes.

Note: Part D is used only as a spacer to move the Club & Ball Washer unit away from your mounting surface.

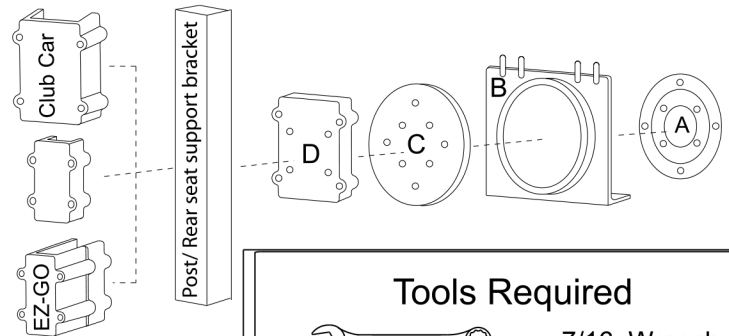

## Tools Required



7/16 Wrench

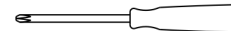

#2 Phillips

